

Peel-Off Projects

Scrap / Suitcase

1. Colour the sticker with a brown Peel-Off marker.
2. Apply the Magic Tape to the Peel-Off sticker.
3. Remove the Magic Tape from the sheet.
4. Apply the sticker to the card.

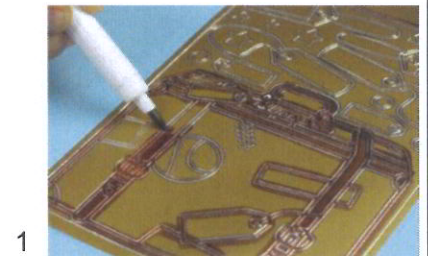

1



2

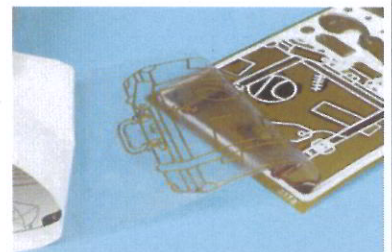

3

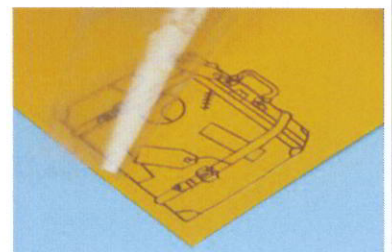

4

Card with case: Requisites: Peel-Off 0113, 0212 gold; Peel-Off markers; cardboard: brown, dark brown; scrap paper 7 Gypsies; leather-look paper; eyelet; cord; foam tape 0.8 mm; inkpad cocoa; punch tool. Accentuate all the edges with stamping ink. Glue a 5 x 12 cm strip as a compartment on the bottom of the card (12 x 24 cm). Glue a strip of dark brown cardboard onto it. Colour in the Peel-Off's with the brown permanent marker, glue the case onto leather-look paper and then apply technique 7. Cut out some labels, punch a hole in them and attach a cord. Glue the case onto the compartment, and slide in the labels, which have been decorated with designer paper and texts. Attach eyelets to the card and insert cord.

Card with knapsack: Requisites: Peel-Off 0112 silver and gold, 1717 gold; Peel-Off markers; punch tool; cord; orange inkpad. A roll of double-sided sticky tape. Glue light-green and designer paper onto a green card (14.8 x 21 cm). Glue the knapsack onto green paper. Glue the back section on the card, attach two bands to it using tape and glue the other ends of the bands behind the front section of the knapsack. Cut out a light-green strip measuring 5 x 28 cm and shape it into a harmonica with 4 sections of 7 cm. Use technique 1 to decorate this with the small Peel-Off patterns. Glue the strip between the front and back section of the knapsack. Punch a hole in the handle and in the card, hang the label on a cord, and slip it through.